

Orona 3G 2025

Machine-room above electrical gearless solutions

With the latest direct drive technology in public buildings.
Less noise and more accessible maintenance.
The customised solution with a machine room and the latest technology.

General specifications

Load	320 to 1,000 kg
Capacity	4 to 13 persons
Speed	1 - 1.6 m/s
Maximum travel	60 m
Maximum floors served	16-21 floors
Entrances	1 front / 2 open through
Drive system	Direct gearless
Controller	ARCA III controller, low energy consumption multiprocessor
Door types	Automatic side-opening / Automatic central-opening
Clear door opening	From 800 to 1,500 mm (in 100 mm increments)
Door height	2,000 / 2,100 / 2,200 / 2,300 mm
Car dimensions	Parametric car dimensions
Internal car height	2,100 / 2,200 / 2,300 / 2,400 mm
Aesthetic solutions	Public Packs Reference / Public Packs Selection / Orona 3G Public Plus

Standard Optional

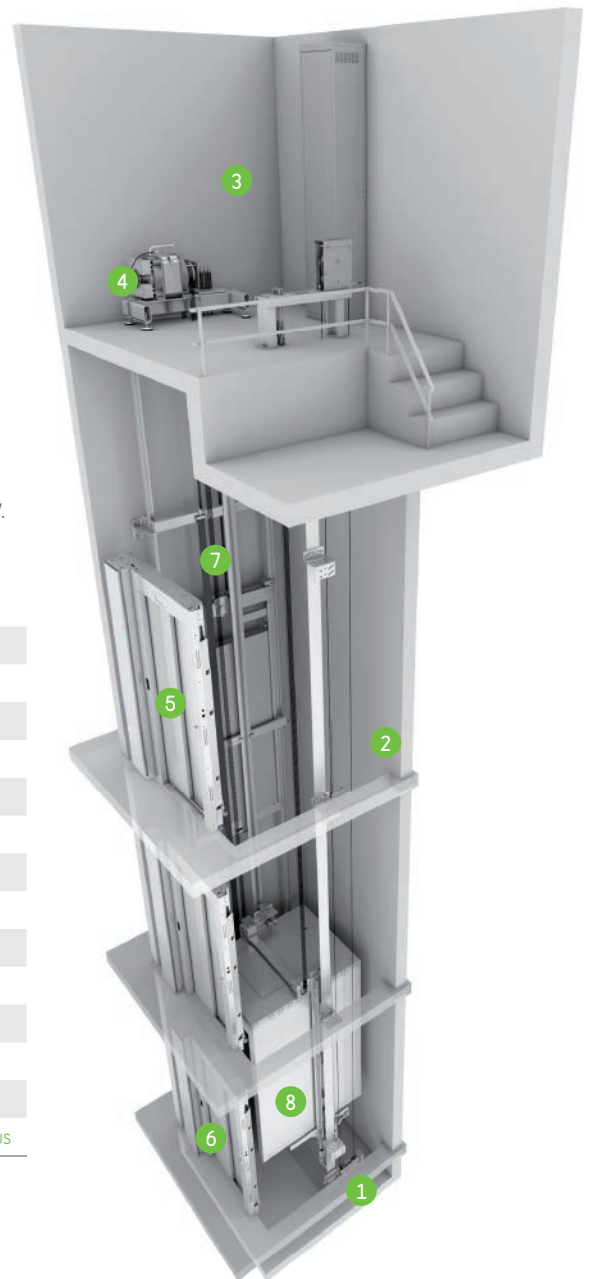

1 ACCESSIBLE SPACE BELLOW THE PIT

Adapts the lift to suit buildings which have an accessible space below the pit (optional).



2 PARAMETRIC/FLEXIBLE

Flexible car and door configurations ensure available shaft dimensions to meet the requirements of the lift well (optional).



3 MACHINE-ROOM

A traditional solution simplifying lift maintenance.



4 DRIVE

Compact, quiet, gearless, energy efficient, speed regulated (VVVF) permanent magnet electric motor.



5 SOLID DOORS

Extra robust doors with reduced sound levels inside and outside the lift and which are specially constructed for high volume passenger traffic.



6 AUTOMATIC RESCUE SYSTEM

With floor level indication to ensure fast, efficient and safe evacuation of passengers in the event of an emergency. As an option, the system can incorporate a fully-automatic rescue device to evacuate passengers in the event of a power failure.



7 TRACTION ROPES

Orona small diameter ropes replace traditional steel ropes. As a result of their lighter weight, longer lifespan and greater flexibility, it is possible to use a more compact, efficient and eco-friendly gearless machine.



8 TWO-WAY COMMUNICATIONS

Between the lift and the emergency 24-hour Service Call Centre according to EN 81-28.



ECO-EFFICIENCY



ADAPTABILITY



DESIGN AND ACCESSIBILITY



CONTROL AND SAFETY

Standard dimensions*

Load / capacity			Car			Lift shaft ⁰							
Speed	Persons	Q Load	AC Width	FC Depth	PL Clear opening	Entrances		Side-opening doors		Central-opening doors		HF Pit	HUP ⁴ Headroom
						Accessibility	No. of entrances	AH Width	FH ¹ Depth	AH Width	FH ² Depth		
1 m/s	6	450 kg	1,000	1,250	800	♿	1	1,470	1,520	1,720	1,470	1,000 (850) ³	3,400
							2x180 ⁰		1,690		1,590		
	8	630 kg	1,100	1,400	900	♿	1	1,570	1,670	1,900	1,620		
							2x180 ⁰		1,840		1,740		
	10	800 kg	1,350	1,400	900	♿	1	1,820	1,670	1,900	1,620		
							2x180 ⁰		1,840		1,740		
	13	1000 kg	1,600	1,400	1,000	♿	1	2,070	1,670	2,100	1,620		
							2x180 ⁰		1,840		1,740		
1							1,870		1,870		2,100	1,820	
2x180 ⁰									2,040			1,940	
13	1,000 kg	1,400	1,600	1,000	♿	1	1,720	2,370	2,100	2,320			
						2x180 ⁰		2,540		2,440			
						1		1,870		1,870	2,100	1,820	
						2x180 ⁰				2,040		1,940	
1,6 m/s	6	450 kg	1,000	1,250	800	♿	1	1,470	1,520	1,720	1,470	1,120	3,550
							2x180 ⁰		1,690		1,590		
	8	630 kg	1,100	1,400	900	♿	1	1,570	1,670	1,900	1,620		
							2x180 ⁰		1,840		1,740		
	10	800 kg	1,350	1,400	900	♿	1	1,820	1,670	1,900	1,620		
							2x180 ⁰		1,840		1,740		
	13	1,000 kg	1,600	1,400	1,000	♿	1	2,070	1,670	2,100	1,620		
							2x180 ⁰		1,840		1,740		
1							1,870		1,870		2,100	1,820	
2x180 ⁰									2,040			1,940	
13	1,000 kg	1,400	1,600	1,000	♿	1	1,720	2,370	2,100	2,320			
						2x180 ⁰		2,540		2,440			
						1		1,870		1,870	2,100	1,820	
						2x180 ⁰				2,040		1,940	

0 Minimum plumb measurements

- 1 Shaft depth with doors tracks projecting 60 mm on the landing (doors adapted 50 mm towards the lift shaft) (std. doors 90 mm sill)
- 2 Shaft depth with doors tracks projecting 40 mm on the landing (doors adapted 34 mm towards the lift shaft) (std. doors 54 mm sill)

3 HF reduced pit optional 850 mm

4 HUP minimum for internal car height (HC) 2,100 mm (HUP=HC+1,300)

Note: minimum AH dimensions calculated with the most favourable combination of controller cabinet and door pillar it is connected to

* The information is not contractually binding and is subject to the conditions of the shaft

Layout*

1 ENTRANCE

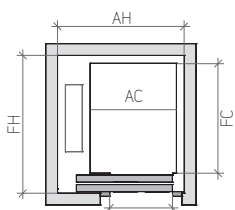

2 ENTRANCES (OPEN THROUGH)

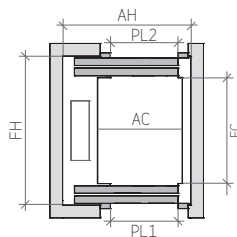

VERTICAL SECTION

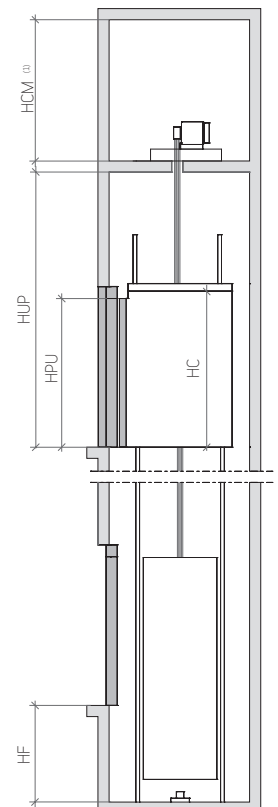

* Note: The diagrams are for guidance only

Customised car dimensions

		Car width										Clear door opening												
		13	12	1,600										800	900	1,000	1,100	1,200	1,300	1,400	1,500			
		13	13	11	1,500																			
		13	13	12	11	10	1,400																	
		13	12	11	10	9	8	1,300																
		13	13	12	11	10	9	8	1,200															
13	13	12	11	11	10	9	8	8	1,100															
12	12	11	10	10	9	8			1,000															
11	10	10	9	8	8				900															
2,100	2,000	1,900	1,800	1,700	1,600	1,500	1,400	1,300	1,200															

Note: Car width and depth variable in increments of 5 mm.

For simplification, table samples show increments of 100 mm.

(1) HCM - minimum 2,000 mm